



OFT Series

- / Kiosk
- / Point of Information
- / Self Checkout Service
- / Vending Machine

Open Frame Tablet

High Performance Bezel-Free Tablet
For Easy Installation

Available in 7"/10"/15"/21"



Intel



Low Power Consumption



Easy Cleaning



Slim Design



Fanless



Multi-OS Support



Cost Effective



High Performance



Home Automation



Gaming



High Performance with Low Cost



	Cost	Performance
Intel® Atom™ Z3735F	\$	👍👍
Intel™ Atom (E3845, J1900)	\$\$\$	👍👍
NXP i.MX6	\$\$	👍

User Centered Design

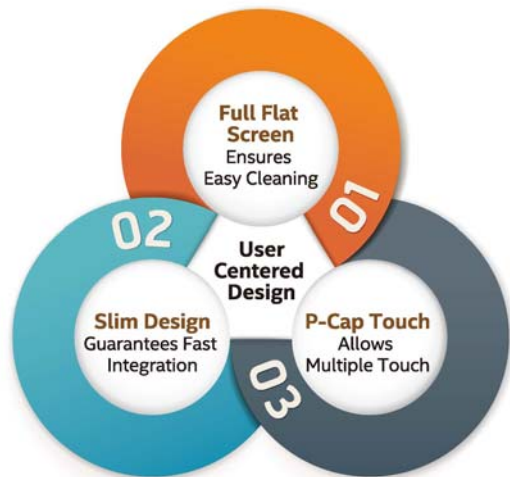

Flush/Wall Mount Design

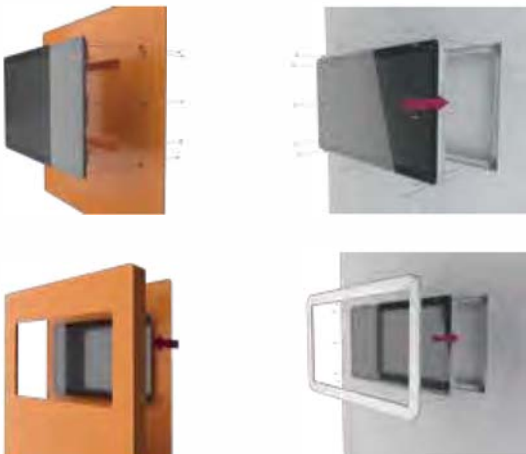

Flush Mounting Concept

Wall Mounting Concept

Fanless /Slim /Fully Flat

- Slim type design for any attractive decoration
- Fully flat touch screen can be cleaned and operated easily
- Efficient integration into any embedded applications
- Projected capacitive touchscreen, with multi touch



Specification



Model Name	OFT-07W01	OFT-10W01	OFT-15W01	OFT-21W01
Panel				
LCD Size	7"	10.1"	15.6"	21.5"
Resolution	1280x800	1280x800	1920x1080	1920x1080
Luminance	300	350	220	250
Viewing angle	160° (H/V)	170° (H/V)	45°(H+)/45°(H-)/20°(V+)/45°(V-)	178°(H/V)
Touch Type	PCAP	PCAP	PCAP	PCAP
System				
Processor	Intel® Atom™ Z3735F 1.33GHz Processor			
System Memory	2GB DDR3L RAM			
Other	Optional 802.11 b/g/n WiFi			
Storage				
Storage	8GB or 32GB eMMC			
I/O				
External I/O Connector	2x USB 2.0, 1x micro USB Client(Android only), 1x 10/100 Ethernet, 1x HDMI, 1x Head phone jack, 1x Micro SD slot, 1x DC jack, 1x RS232(TX/RX) or RS485			
Internal I/O Connector	1x 16 bit GPIO interface, 1x USB interface, 1x eDP & Dual channel 24bit LVDS, 1x backlight control & power, 2x speaker interface (1.2W stereo), 1x A-MIC interface, 1x Touch Button connector, 1x DC input 4pin header, 1x I2C interface(optional)			
Mechanical & Environmental				
Power Requirement	19V DC input			
Power Type	DC Jack, DC input 4pin header, optional Power Over Ethernet 802.3AT			
Operating Temp	0°C ~ 40°C			
Storage Temp	-20°C ~ 60°C0			
Dimension	7.2" x 4.6" x 1.0"	10" x 6.5" x 1.3"	15.2" x 9.3" x 1.3"	17.7" x 10.4" x 1.6"
Software Support				
Software Support	Windows 8.1/ Windows 10/ Android 4.4/ Ubuntu 14.04			



BCM Advanced Research
 11 Chrysler, Irvine, CA 92618 USA
 Tel: +1-949-470-1888
 Fax: +1-949-470-0971
 E-mail: BCMSales@bcmcom.com
 Web: www.bcmcom.com



All specifications are subjects to change without notification.
 All brand names and registered trademarks referred to in this catalog are the property of their respective companies.
 Copyright © BCM Advanced Research, an Avalue Company